

**Thule Console**

# ➤ **Instructions**

## PARTS DESCRIPTION

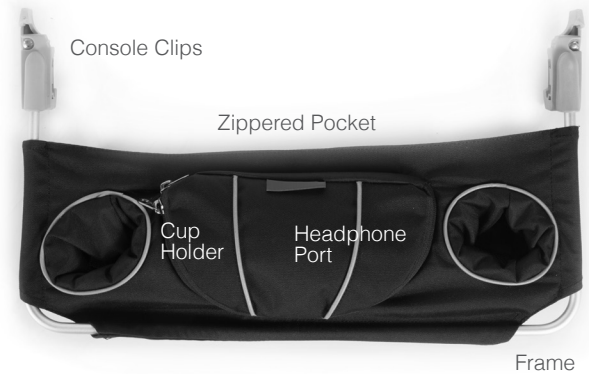

## GENERAL WARNING

These instructions contain many WARNINGS. Read and understand all of the WARNINGS. Failure to assemble and use this accessory correctly may lead to serious personal injury to your passenger.

- For the Thule Console to be secured to the Thule Accessory Cross Bar, both quick release levers on the Thule Console clips must be fully closed. Failure to fully close the clips could result in the Thule Console separating from the Thule child carrier.
- Do not exceed the maximum capacity of 1.4kg/3lb in the Thule Console as the Thule child carrier could become unstable.
- Do not place sharp and/or heavy objects in the Thule Console.
- The Thule Console is for small items only, not for children or pets!

## 1.0 THULE CONSOLE INSTALLATION AND REMOVAL

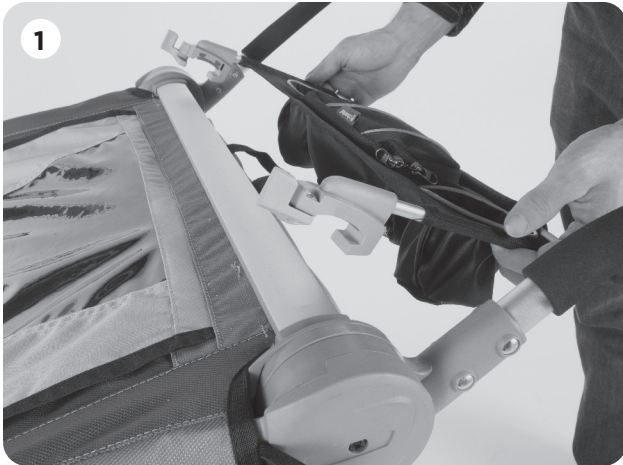

- A. From the rear of the Thule carrier, place both Thule Console clips over the Thule Accessory Cross Bar. (See image 1)
- B. Open the quick release levers and hook the clips over the Thule Accessory Cross Bar until the clips sit evenly on the bar. (See image 2)
- C. Close the quick release levers fully so that the Thule Console fits tightly onto the bar. (See image 3)
- D. To remove the Thule Console, open the quick release levers fully and pull off the Thule Console.

## 2.0 PROPER USE OF THE THULE CONSOLE



- A. Place your cargo into the Thule Console. The item(s) can be secured with either the cup holder or the zippered pocket. (See image 4)





### WARNING

The Thule Console is designed for carrying light items only! The maximum capacity of the Thule Console is 1.4 kg/3 lb.

### NOTICE

Your Thule child carrier can experience sharp movements during use. Ensure that all Thule Console contents are securely restrained.

 Thule Child Transport Systems Ltd.  
105 - 5760 9th Street SE Calgary, AB T2H 1Z9 Canada

 [info@thule.com](mailto:info@thule.com)

 [www.thule.com](http://www.thule.com)

» PART OF THULE GROUP